

# DS-4046 & DS-4060 ASSEMBLY INSTRUCTIONS

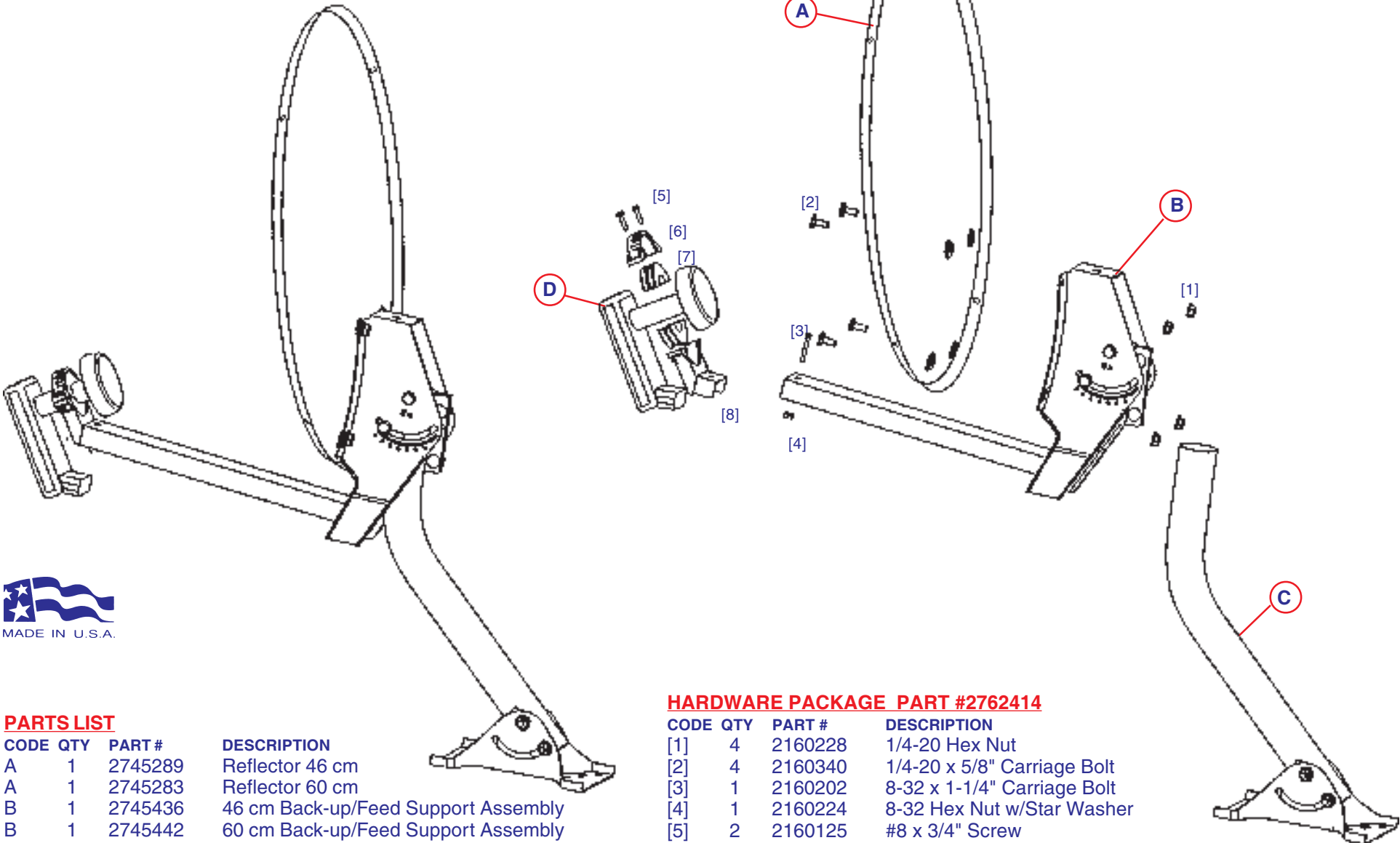

**PARTS LIST**

CODE	QTY	PART #	DESCRIPTION
A	1	2745289	Reflector 46 cm
A	1	2745283	Reflector 60 cm
B	1	2745436	46 cm Back-up/Feed Support Assembly
B	1	2745442	60 cm Back-up/Feed Support Assembly
C	1	2745404	46 cm Base/Tube Assembly
C	1	2744596	60 cm Base/Tube Assembly
D	1	N/A	LNBF - Not Supplied
		2762414	Hardware Package

**HARDWARE PACKAGE PART #2762414**

CODE	QTY	PART #	DESCRIPTION
[1]	4	2160228	1/4-20 Hex Nut
[2]	4	2160340	1/4-20 x 5/8" Carriage Bolt
[3]	1	2160202	8-32 x 1-1/4" Carriage Bolt
[4]	1	2160224	8-32 Hex Nut w/Star Washer
[5]	2	2160125	#8 x 3/4" Screw
[6]	1	3200687	Feed Clamp Top
[7]	2	3200690	Feed Clamp Shims (23 mm throat)
	2	3200695	Feed Clamp Shims (40 mm throat)
[8]	1	3200689	Feed Clamp Base