

### ATTACHING ANTENNA TO MAST

Loosen U-bolt nuts. Slide U-bolt over mast. Point small end of antenna toward stations and tighten securely. See Figure 7. The 75 ohm coaxial cable downlead may be secured to mast by taping or by using plastic wire ties.

### ATTACHING THE COAX

Now that the antenna is secured to the mast, connect the 75 ohm coaxial cable to the matching transformer. The connection should be finger tight. The coaxial downlead may be secured to the mast by either taping it or use of plastic wire ties.

Fig. 7

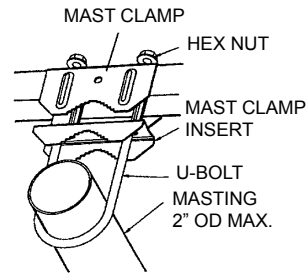

### HOW TO PROVIDE LIGHTNING PROTECTION FOR TV ANTENNA AND SET

**Step 1.** Mount the grounding block as close as possible to where the 75 ohm coaxial cable downlead enters the house. See Figure 8.

**Step 2.** The ground wires for both the mast and the downlead should be copper or aluminum wire, number eight (8) or larger. See Figure 8.

**Step 3.** The downlead wire from the antenna to the grounding block and the mast ground wire should be secured to the house spaced from four (4) to six (6) feet apart. See Figure 8.

**NOTE:** In the case of a "ground up" antenna installation, it may not be necessary to ground the mast if the mast extends four or more feet into the earth. Consult a TV serviceman for the proper depth in your location.

Fig. 8

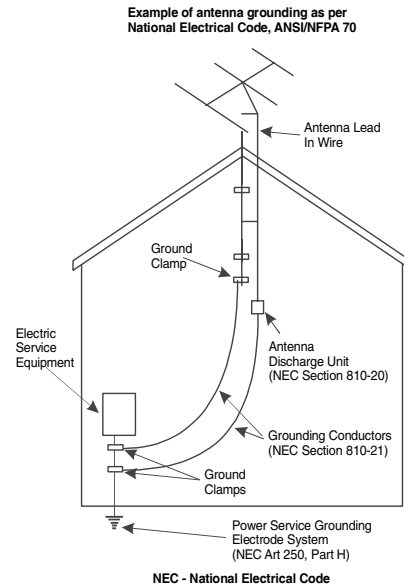

## High Definition (HD) Platinum Antenna

### INSTRUCTIONS VHF/UHF MODEL HD7000R

**WARNING**  
**INSTALLATION OF THIS ANTENNA NEAR POWER LINES IS DANGEROUS. FOR YOUR SAFETY, FOLLOW THE INSTALLATION INSTRUCTIONS.**

#### 90 DAY LIMITED WARRANTY

Winegard Company warrants this Winegard product against any defects in materials or workmanship within 90 (ninety) days from date of purchase. No warranty claim will be honored unless at the time the claim is made, you present proof of purchase to an authorized Winegard dealer (if unknown, please contact Winegard Company, 3000 Kirkwood Street, Burlington, IA 52601-2000, Telephone 800-288-8094).

Winegard Company (at its option) will either repair or replace the defective product at no charge to you. This warranty covers parts, but does not cover any costs incurred in removal, shipping or reinstallation of the product. This limited warranty does not apply if the product is damaged, deteriorates, malfunctions or fails from: misuse, improper installation, abuse, neglect, accident, tampering, modification of the product as originally manufactured by Winegard, usage not in accordance with product instructions or acts of nature such as damage caused by wind, lightning, ice or corrosive environments such as salt spray and acid rain.

The 90 Day Warranty is provided on the condition that the equipment is properly delivered with all handling and freight charges prepaid to your Winegard dealer for return to our factory for repair or replacement. Winegard dealers will arrange for the replacement or repair and return to you without charge the product which failed due to defective material or workmanship.

WINEGARD COMPANY WILL NOT ASSUME ANY LIABILITIES FOR ANY OTHER WARRANTIES, EXPRESS OR IMPLIED, MADE BY ANY OTHER PERSON.

ALL OTHER WARRANTIES WHETHER EXPRESS, IMPLIED OR STATUTORY INCLUDING WARRANTIES OF FITNESS FOR A PARTICULAR PURPOSE AND MERCHANTABILITY ARE LIMITED TO THE 90-DAY PERIOD OF THIS WARRANTY.

The foregoing shall be the sole and exclusive remedy of any person, whether in contract, tort or otherwise, and Winegard shall not be liable for incidental or consequential damage or commercial loss, or from any other loss or damage except as set forth above.

Some states do not allow limitations on how long an implied warranty lasts, or the exclusion of limitation of incidental or consequential damages, so the above limitations or exclusions may not apply to you.

This warranty gives you specific legal rights and you may also have other rights which vary from state to state.

Rev. 2/08

**STEP 1.** Remove antenna and hardware bag from carton.

**STEP 2.** Unfold the Tetrapoles. Make sure that they lock into place. See Figure 1.

**Fig. 1**

The VHF Elements in this drawing have been removed to make the Tetrapoles easier to identify.

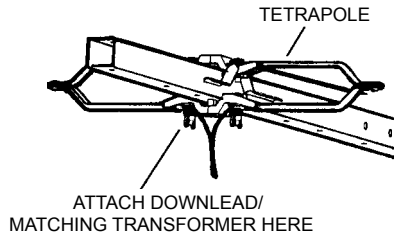

**STEP 3.** Unfold the shorter VHF Elements on underside of the boom until they lock into place. See Figure 2.

**Fig. 2**

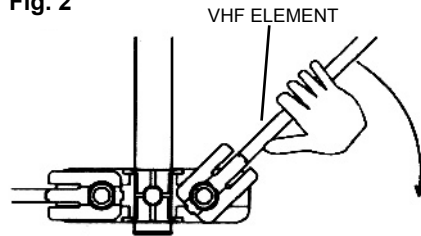

**STEP 4.** Insert the U-bolt into the Mast Clamp Insert. Then insert the U-Bolt into the Mast Clamp on the antenna and loosely thread the Hex Nuts onto the U-bolt as shown in Figure 3. **Do Not** tighten the Hex nuts at this point.

**Fig. 3**

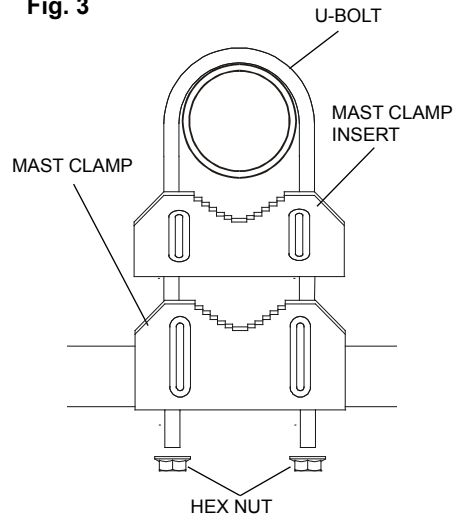

**STEP 5.** Install the Matching Transformer using the smaller hex nuts and washers in your hardware bag. Make sure to place the leads **between** the two washers on each post. See Figure 4. Then tighten the hex nuts to secure the leads.

**Fig. 4**

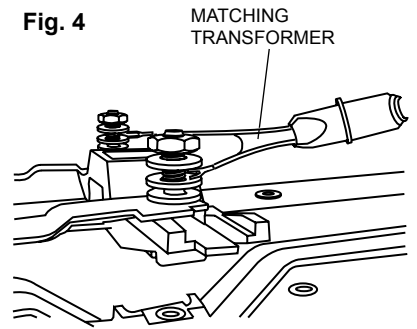

**STEP 6.** Flip the antenna over and unfold all of the long VHF elements until they lock into place. Be sure the elements are locked into position and are flat and parallel to each other. See Figure 2.

**Fig. 5**

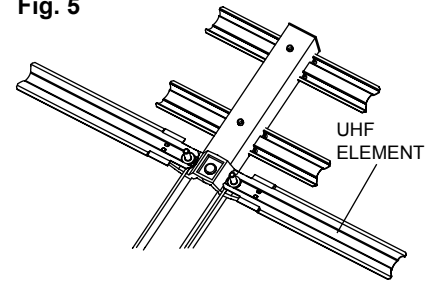

**STEP 7.** Unfold the UHF elements. Shown in Figure 5.

**STEP 8.** Insert the plastic end caps. As shown in Figure 6. Use a rubber mallet to gently tap them into the antenna booms to secure them.

**Fig. 6**

